

BATH ACCESSORIES & HARDWARE

- TUB SPOUTS
- DIVERTER SPOUTS
- SHOWER HEADS
- SHOWER ARMS
- SHOWER PARTS
- BATHROOM ACCESSORIES
 - COMMERCIAL BATHROOM ACCESSORIES
 - HANDS-FREE SENSORED SOAP DISPENSERS
 - HANDS-FREE SENSORED TOWEL DISPENSERS
 - HANDS-FREE SENSORED FAUCETS
 - HANDS-FREE SENSORED FLUSH VALVES
 - HANDS-FREE PARTS & ACCESSORIES

Tub Spouts

TUB SPOUT

- 1/2" I.P.S. Inlet

Part#	description	finish
190010	chrome plated zinc	CP



TUB SPOUT WITH FACING BUSHING

- With 3/4" to 1/2" I.P.S. Reducing Bushing

Part#	description	finish
190013	chrome plated zinc	CP



ADJUSTABLE TUB SPOUT WITH FACING BUSHING

- With 3/4" to 1/2" I.P.S. Reducing Bushing
- Adjusts up to 1"

Part#	description	finish
190015	chrome plated zinc	CP



SLIDE-ON TUB SPOUT

- For Use With 1/2" Nom. (5/8" O.D.) Copper Pipe
- Slide On With Set Screw

Part#	description	finish
190017	chrome plated zinc	CP



BRASS TUB SPOUT WITH BUSHING

- Brass Construction
- With 3/4" to 1/2" I.P.S. Reducing Bushing

Part#	description	finish
190019	chrome plated brass	CP



Diverter Spouts

DIVERTER SPOUT

- Diverter On Nose
- 1/2" I.P.S. Thread On Nose

Part#	description	finish
190030	chrome plated zinc	CP
190032	brushed nickel zinc	BN



BRASS DIVERTER SPOUT

- Diverter On Nose
- 1/2" I.P.S. Thread On Nose

Part#	description	finish
190035	chrome plated brass	CP



DIVERTER SPOUT WITH FACE BUSHING

- Diverter On Body
- 3/4" I.P.S.
- With 3/4" to 1/2" I.P.S. Reducing Bushing

Part#	description	finish
190037	chrome plated zinc	CP
190039	polished brass zinc	PB



BRASS DIVERTER SPOUT WITH FACE BUSHING

- Diverter On Body
- With 3/4" to 1/2" I.P.S. Reducing Bushing

Part#	description	finish
190045	chrome plated brass	CP



ADJUSTABLE DIVERTER SPOUT

- Diverter On Nose
- With 3/4" to 1/2" I.P.S. Inlet
- Adjusts Up To 1"

Part#	description	finish
190047	chrome plated zinc	CP



Diverter Spouts

SLIDE-ON DIVERTER SPOUT

- Diverter On Nose
- For Use With 1/2" Nom. (5/8" O.D.) Copper Pipe
- Slide On With Set Screw

Part#	description	finish
190050	chrome plated zinc	CP
190052	chrome plated brass	CP
190054	brushed nickel zinc	BN



Brushed Nickel

DIVERTER SPOUT WITH OUTLET

- Diverter On Body
- With 3/4" to 1/2" I.P.S. Reducing Bushing
- 1/2" I.P.S. Outlet For Hand Held Shower Connections

Part#	description	finish
190065	bottom outlet die-cast	CP



DIVERTER SPOUT WITH OUTLET

- Diverter On Body
- With 3/4" to 1/2" I.P.S. Reducing Bushing
- 1/2" I.P.S. Outlet For Hand Held Shower Connections

Part#	description	finish
190069	side outlet die-cast	CP



BRASS REDUCING BUSHING

- Flush Bushing

Part#	description
190072	1/2" M.I.P x 3/8" F.I.P.
190074	3/4" M.I.P x 1/2" F.I.P.



Shower Heads

ECONOMY SHOWER HEAD - 2.0 GPM

- ABS Construction
- 2" Adjustable White Face
- 1/2" F.I.P.



Part#	description	finish
190080	plastic ball joint	CP
190082	metal ball joint	CP

Shower Heads

SHOWER HEAD - 2.5 GPM

- ABS Construction
- 3" Adjustable White Face
- 1/2" F.I.P.
- Clear Acrylic Body Sleeve



Part#	description	finish
190115	metal ball joint	CP

ECONOMY SHOWER HEAD - 2.5 GPM

- ABS Construction
- 2" Adjustable Black Face
- 1/2" F.I.P.



Part#	description	finish
190090	plastic ball joint	CR

SHOWER HEAD - 2.5 GPM

- ABS Construction
- 2" Adjustable Black Face
- 1/2" Inlet



Part#	description	finish
190122	brass ball joint	CP

ECONOMY SHOWER HEAD - 2.5 GPM

- ABS Construction
- 2" Adjustable Black Face
- 1/2" F.I.P.



Part#	description	finish
190094	metal ball joint	PB

DELUXE BRASS SHOWER HEAD - 2.5 GPM

- Brass Construction
- 3" Face
- 1/2" F.I.P.



Part#	description	finish
190124	3" face	CP

SHOWER HEAD - 5.0 GPM

- ABS Construction
- 2" Adjustable Face
- 1/2" F.I.P.



Part#	description	finish
190100	black face	CR
190105	white face	CR

DELUXE BRASS BELL SHOWER HEAD - 2.5 GPM

- Brass Construction
- 4" Face
- 1/2" F.I.P.



Part#	description	finish
190126	4" face	CP
190128	4" face	BN

SHOWER HEAD - 2.5 GPM

- ABS Construction
- 2" Adjustable White Face
- 1/2" F.I.P.



Part#	description	finish
190112	metal ball joint	CP

DELUXE BRASS SHOWER HEAD - 2.0 GPM

- Brass Construction
- Adjustable Side Handle
- 1/2" F.I.P.



Part#	description	finish
190132	1-3/4" face	CP
190134	2-1/4" face	CP

Shower Heads

DELUXE BRASS SHOWER HEAD - 2.0 GPM

- Brass Construction
- Adjustable Side Handle
- 1/2" F.I.P.



Part#	description
190131	1-3/4" face
190135	2-1/4" face

finish
BN
BN

Shower Heads

MASSAGE SHOWER HEAD - 2.5 GPM

- White/Gray ABS Body
- Massage & Shower Spray Adjustment
- 1/2" F.I.P. Inlet



Part#	description
190192	brass ball joint

finish
N/A

DELUXE METAL SHOWER HEAD - 2.0 GPM

- Metal Body & Ball Joint
- Adjustable Side Handle
- 1/2" F.I.P.



Part#	description
190152	2" face
190154	3" face

finish
CP
CP

PULSATING MASSAGE SHOWER HEAD - 2.5 GPM

- ABS Body
- Pulsating 3-way Adjustment
- 3" Adjustable White Face
- 1/2" F.I.P.



Part#	description
190202	brass ball joint
190204	metal ball joint

finish
CP
CP

WATER SAVING SHOWER HEAD - 2.0 GPM

- Brass Construction
- 1/2" F.I.P.



Part#	description
190162	with shut-off
190164	without shut-off

finish
CP
CP

MASSAGE SHOWER HEAD - 2.5 GPM

- ABS Body
- 5 Function Settings
- Gray Face w/Self Clean Rubber Jets
- 1/2" F.I.P. Inlet



Part#	description
190212	brass ball joint

finish
CP

WATER SAVING SHOWER HEAD - 1.8 GPM

- Brass Construction
- 1/2" F.I.P.



Part#	description
190172	brass ball joint

finish
CP

PULSATING MASSAGE SHOWER HEAD - 2.5 GPM

- ABS Body
- Pulsating 5-way Adjustment
- 3" Adjustable White Face
- 1/2" F.I.P.



Part#	description
190222	brass ball joint

finish
CP

OCTAGONAL SHOWER HEAD - 2.0 GPM

- Metal Construction
- 4" Face
- 1/2" F.I.P.



Part#	description
190182	metal ball joint

finish
CP

Shower Heads

**PULSATING MASSAGE
HAND-HELD SHOWER -
2.0 GPM**

- Non-Metallic
- Pulsating 3-way Adjustment
- 3" Adjustable White Face



Part#	description	finish
190230	w/59" CP metal flex hose & bracket	CP

**REPLACEMENT SHOWER
HOSE**

- 59" Flex Hose
- Clear Vinyl w/Silver Mylar Strapping
- 1/2" F.I.P. Inlets



Part#	description	finish
190232	59" flex hose	N/A

REPLACEMENT BRACKET

- ABS Construction



Part#	description	finish
190234	hand-held rep. bracket	CR

**BRASS RAINSHOWER
SHOWER HEAD - 2.5 GPM**

- Brass Construction
- Attaches To Shower Arm
- Self Cleaning Spray Tips
- 1/2" F.I.P. Inlet



Part#	description	finish
190300	5-1/2" face	CP

**BRASS RAINSHOWER
SHOWER HEAD - 2.5 GPM**

- Brass Construction
- Self Cleaning Spray Tips
- 1/2" F.I.P.



Part#	description	finish
190301	4" face	CP

Shower Arms

SHOWER ARM

- Brass Construction
- 1/2" M.I.P. On Both Ends



Part#	description	finish
190311	6"	CP
190315	8"	CP
190317	6"	BN

Shower Arms

ADJUSTABLE SWIVEL SHOWER ARM

- Brass Construction
- Fits Standard 1/2" Pipe
- Swings Up & Down To Adjust Shower Head Height



Part#	description	finish
190366	brass	CP

ABS SHOWER ARM WITH PLASTIC FLANGE

- ABS Construction
- 1/2" M.I.P. On Both Ends



Part#	description	finish
190321	7-1/4"	CP

"S" SHAPE SHOWER ARM WITH STEEL FLANGE

- Brass Construction
- 1/2" M.I.P. On Both Ends



Part#	description	finish
190377	11" H	CP

SHOWER ARM WITH METAL FLANGE

- Brass Construction
- 1/2" M.I.P. On Both Ends



Part#	description	finish
190331	6"	CP

Shower Parts

SHOWER ARM FLANGE

- Fits All 1/2" Shower Arms



Part#	description	finish
190400	ABS w/set screw	CP
250270	steel construction	CP
190404	brushed nickel (not shown)	BN
190406	polished brass (not shown)	PB

SHOWER ARM WITH METAL FLANGE

- Brass Construction
- 1/2" M.I.P. On Both Ends



Part#	description	finish
190346	6"	PB

BALL JOINT SHOWER ARM ADAPTER

- Converts Ball Shower Arms To Standard Thread



Part#	description	finish
190415	1/2" I.P.S. x 1-1/8"-20 thread	CP

Part#	description	finish
190417	1/2" I.P.S. x 1-1/8"-14 thread	CP

Part#	description	finish
190419	1/2" I.P.S. x 1-1/4"-14 thread	CP

BALL JOINT SHOWER ARM

- Brass Construction
- 1/2" M.I.P. x Ball Joint
- Fits Price Pfister & Gerber Shower Heads



Part#	description	finish
190356	6"	CP

Shower Parts

THINWALL SHOWER STALL ELBOW

- Used To Install Shower Arm On Fiberglass Or Acrylic Shower Units
- For 1/2" Copper Or Iron Pipe



Part#	description	finish
190420	1/2" w/two nuts	N/A

SHOWER HEAD VOLUME CONTROL

- Fits Standard 1/2" Shower Arm



Part#	description	finish
190433	brass	CP

SHOWER HEAD FLOW RESTRICTOR

- Fits Standard 1/2" Shower Heads
- Restricts Flow To 2.0 GPM



Part#	description	finish
190444	black rubber	N/A

Bathroom Accessories

ADJUSTABLE SHOWER ROD FLANGE



Part#	description	finish
190450	ABS	CP
190452	ABS	PB
190454	die-cast	CP

SHOWER ROD FLANGE (pair)

- FHA Type With Screws
- Steel



Part#	description	finish
190460	exposed screw	CP
190461	concealed screw	CP

SHOWER CURTAIN RING (24 rings per bag)



Part#	description	finish
190470	nickel plated steel	N/A

ALUMINUM SHOWER ROD

- 1" - .025 Gauge



Part#	description	finish
190480	1" x 5'	AL
190488	1" x 6'	AL

STAINLESS STEEL SHOWER ROD

- 1" - .012 Wall Thickness



Part#	description	finish
190490	1" x 5'	SS

Bathroom Accessories

SHOWER ROD COVER

- PVC Snap-on Cover
- Fits 1" Diameter Shower Rod



Part#	description	finish
190493	5'	WHT
190495	5'	IVY

ADJUSTABLE SHOWER ROD

- Spring Tension Bar Adjusts Up To 72"
- Rubber End Caps



Part#	description	finish
190500	spring tension rod	CP
190505	spring tension rod	WHT

BATHTUB SPLASH GUARD (pair)

- Complete With Adhesive Back
- 7"W x 9"H



Part#	description	finish
190520	bathtub splash guard	WHT

SHOWER SPLASH GUARD (pair)

- Complete With Adhesive Back
- 48"H



Part#	description	finish
190530	shower splash guard	WHT

PLASTIC MIRROR PULL (pair)

- Complete With Adhesive Back
- Textured Finish
- 2-1/4"H x 3/4"W



Part#	description	finish
190540	plastic mirror pull	BLK
190546	plastic mirror pull	clear

Bathroom Accessories

PLASTIC CABINET/MIRROR PULL (2 pair)

- Complete With Adhesive Back
- 3-1/4"H x 1"W



Part#	description	finish
190549	plastic cab/mirror pull	clear

TOWEL SHELF & BAR

- Exposed Screw
- 24" long Extends 8-1/4"
- Heavy Duty - Stainless Steel



Part#	description	finish
190560	towel shelf/bar	CP

TOWEL BAR BRACKETS



Chrome Plated Exposed



Chrome Plated Concealed



Polished Brass Concealed

Part#	description	finish
190570	5/8" exposed screw	CP
190571	3/4" exposed screw	CP
190573	5/8" concealed screw	CP
190577	3/4" concealed screw	CP
190579	3/4" concealed screw	PB

MIRROR FINISH TOWEL BAR

- Aluminum
- Square Bar



Polished Brass



Chrome Plated

Part#	description	finish
190590	5/8" x 18"	CP
190591	5/8" x 24"	CP
190593	5/8" x 36"	CP
190595	3/4" x 18"	CP
190596	3/4" x 24"	CP
190598	3/4" x 36"	CP
190599	3/4" x 24"	PB

Bathroom Accessories

MIRROR FINISH TOWEL BAR

- Stainless Steel
- Square Bar



Part#	description	finish
190630	5/8" x 18"	CP
190631	5/8" x 24"	CP
190635	3/4" x 18"	CP
190637	3/4" x 24"	CP

AJUSTABLE PLASTIC TOWEL BAR

- Spring Loaded Adjustable End Caps
- Cut To Fit
- Fits 5/8" or 3/4" Brackets



Part#	description	finish
190650	24"	clear
190652	24"	white
190654	36"	clear
190656	36"	white

WHITE PLASTIC TOWEL BAR

- Cut To Fit
- Fits 3/4" Brackets Or Use With Adjustable Towel Bar End Caps



Part#	description	finish
190676	36"	white

ADJUSTABLE TOWEL BAR END CAPS

- Spring Loaded
- Fits 5/8" or 3/4" Brackets



Part#	description	finish
190687	plastic w/steel spring	N/A

Bathroom Accessories

ROBE HOOK

- Surface Mount
- Concealed Screw



Part#	description	finish
190690	single hook	CP
190691	double hook	CP
190695	double hook	PB

SOAP DISH

- Surface Mount



Part#	description	finish
190700	exposed screw	CP
190701	concealed screw	CP

RECESSED SOAP DISH & GRAB BAR

- Metal
- 4-1/2" x 5-1/4" R.I.



Part#	description	finish
190711	rec.grab bar/soap dish	CP
190713	rep. plastic soap dish	N/A

TOOTHBRUSH/TUMBLER HOLDER

- Surface Mount



Part#	description	finish
190720	exposed screw	CP
190722	concealed screw	CP

TOWEL RING

- Surface Mount
- Metal
- Clear Lucite Ring



Part#	description	finish
190730	exposed screw	CP
190733	concealed screw	CP
190736	concealed screw	PB

Bathroom Accessories

TOILET PAPER HOLDER

- Metal - Polished Chrome or Polished Brass Finish
- Surface Mount
- Includes White Roller



Part#	description	finish
190744	exposed screw	CP
190746	concealed screw	CP
190748	concealed screw	PB

TOILET PAPER HOLDER - RECESSED

- Metal
- 5-1/4" x 5-1/4" R.I.
- Includes White Roller



Part#	description	finish
190750	rec.toilet paper holder	CP

CLAMP & SPRING FOR RECESSED FIXTURE

- Used To Install Recessed Soap/ Grab Bar & Toilet Paper Holder



Part#	description	finish
190766	mounting clamp & spring	CP

TOILET PAPER ROLLER

- Spring Action
- ABS Material



Part#	description	finish
190770	5/8" round ends	white
190773	5/8" round ends	CP
190775	3/8" stepped ends	white
190777	3/8" stepped ends	CP

FOUR-PIECE BATHROOM SET

- Includes: 5/8"x 24" Aluminum Towel Bar Set, Metal Soap Dish, Toothbrush/ Tumbler Holder & Toilet Paper Holder



Part#	description	finish
190788	4-piece set	CP

Bathroom Accessories

PLASTIC MIRROR CLIP

- Holds Up To 1/4" Thickness
- Includes Screws



Part#	description	finish
120720	5/8" x 3/4"	plastic
120725	1" x 1-1/8"	plastic

LAVATORY LEGS

- 28" Chrome - Adjustable
- For Wall Mount Basins



Part#	description	finish
191010	adjustable - per pair	chrome

LAVATORY SINK HANGER

- V-Type
- Steel



Part#	description	finish
191022	steel	N/A

Commercial Bathroom Accessories

COMMERCIAL GRADE GRAB BAR

- Heavy Duty 18 Gauge 304 Stainless Steel
- Includes Mounting Screws-Concealed Style
- Satin Stainless Finish
- Meets ADA Specs.



Part#	description	finish
190800	1-1/2"O.D. x 18"L	ST
190801	1-1/2"O.D. x 24"L	ST
190805	1-1/2"O.D. x 36"L	ST
190809	1-1/2"O.D. x 42"L	ST

LIQUID SOAP DISPENSER

- Push Up Valve
- 16-oz. Poly-Globe
- Chrome-plated Surface Mount Bracket & Valve



Part#	description	finish
190830	liquid soap dispenser	CP

MULTI-FOLD PAPER TOWEL DISPENSER

- Heavy Duty Key Lock
- 11-1/4"L x 15-3/8"H x 4-1/16"W



Part#	description	finish
190840	towel dispenser	CP
190844	towel dispenser	WHT

TISSUE HOLDER

- Push Button Arm Release
- 5-1/2"L x 2-3/8"H x 4-1/4"W



Part#	description	finish
190950	single roll tissue holder	CP

Hands-Free Sensored Soap Dispensers

SENSORED SOAP DISPENSER 6315
LAVATORY MOUNTED



- ADA Compliant
- Reliable Infrared Metering Activation
- Chrome Plated Plastic 5-1/2" Spout
- LED Indicators For Low Battery/Low Soap Refill
- Battery Powered (4 "D" Cell Batteries - not included)
- Soap Bottle Sold Separately (part# 190LSB1/190LSB2)



Part#	description	finish
B19000	sensored soap dispenser	CP

Hands-Free Parts & Accessories

REPAIR PARTS



- **For Sensored Soap Dispenser 6315**
Part# B19000
- Chrome Plated Plastic 5-1/2" Spout
- 4 "D" Cell Batteries For Battery Pack not included



Part#	description
1. 19000SK	spout assembly w/sensor cord
2. 19000BT	battery box w/connecting cord
3. 19000MA	motor assembly
4. 19000CLP	c-clip
5. 19000BC	bottle clip

AC ADAPTERS



- Optional Power Source For Sensored Soap Dispenser 6315 - Part# B19000

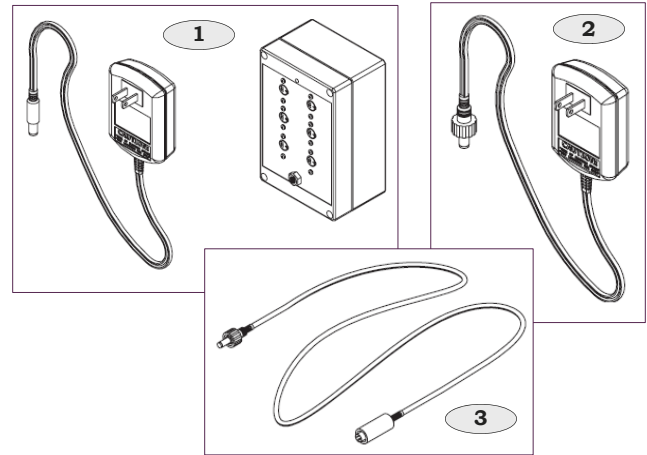

Part#	description
1. 19000AP4	AC adapter for up to 4 dispensers
2. 19000AP1	AC adapter for single dispenser
3. 19000WA	wire assembly (1 needed per soap dispenser to be connected to 19000AP4)

LIQUID SOAP WITH MOISTURIZER



- **For Sensored Soap Dispenser 6315**
Part# B19000
- Sold In Case Quantities - 4 Bottles Per Case
- Two Convenient Sizes



Part#	description
190LSB1	27oz. - 1000 shot
190LSB2	54oz. - 2000 shot