

**Hands-Free Parts & Accessories**

**REPAIR PARTS**



- **For Sensored Soap Dispenser 6315**  
**Part# B19000**
- Chrome Plated Plastic 5-1/2" Spout
- 4 "D" Cell Batteries For Battery Pack not included



Part#	description
1. 19000SK	spout assembly w/sensor cord
2. 19000BT	battery box w/connecting cord
3. 19000MA	motor assembly
4. 19000CLP	c-clip
5. 19000BC	bottle clip

**AC ADAPTERS**



- Optional Power Source For Sensored Soap Dispenser 6315 - Part# B19000

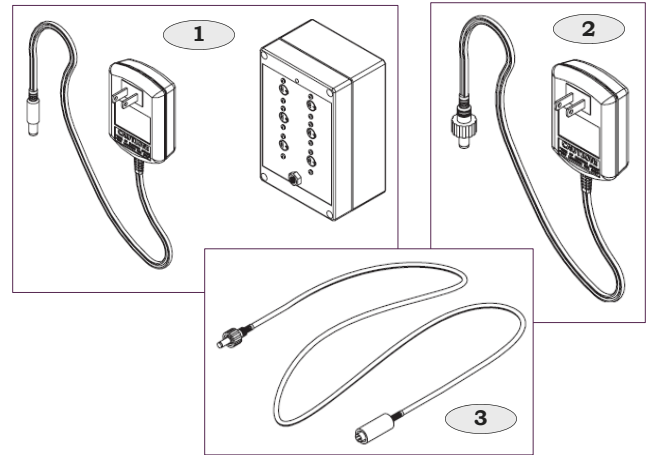

Part#	description
1. 19000AP4	AC adapter for up to 4 dispensers
2. 19000AP1	AC adapter for single dispenser
3. 19000WA	wire assembly (1 needed per soap dispenser to be connected to 19000AP4)

**LIQUID SOAP WITH MOISTURIZER**



- **For Sensored Soap Dispenser 6315**  
**Part# B19000**
- Sold In Case Quantities - 4 Bottles Per Case
- Two Convenient Sizes

Part#	description
190LSB1	27oz. - 1000 shot
190LSB2	54oz. - 2000 shot

